



Docket No. 49841

Notice to Neighboring Systems, Landowners, and Cities
NOTICE OF APPLICATION TO AMEND A CERTIFICATE OF CONVENIENCE AND NECESSITY TO
PROVIDE WATER AND SEWER UTILITY SERVICE IN GUADALUPE COUNTY, TEXAS

To: Guadalupe County Judge
101 E. Court Street
Seguin, Texas 78155

Date Notice Mailed: January 21, 2020

The City of Schertz has filed an application with the Public Utility Commission of Texas to amend its water Certificate of Convenience and Necessity (CCN) No. 10645 and sewer CCN No. 20271 for the provision of retail water and sewer utility service in Guadalupe County.

The requested area is located approximately 1.27 miles northwest of downtown Schertz, Texas, and is generally bounded on the north by Savannah Drive; on the east by the intersection of Maske Road and Oak Street; on the south by the intersection of FM 1518 and Windy Meadows Drive; and on the west by Suncliff Drive. The total requested area includes approximately 67 acres and .Q current customers.

See enclosed map showing the requested area.

The requested area overlaps the boundaries of Cibolo Creek Municipal Authority. If Cibolo Creek Municipal Authority does not request a public hearing, the Commission shall determine that the district is consenting to the City of Schertz's request to provide retail water and sewer utility service in the requested area.

Persons who wish to intervene in the proceeding or comment upon action sought should contact the Public Utility Commission, P.O. Box 13326, Austin, Texas 78711-3326, or call the Public Utility Commission at (512) 936-7120 or (888) 782-8477. Hearing- and speech-impaired individuals with text telephones (TTY) may contact the commission at (512) 936-7136. The deadline for intervention in the proceeding is (30 days from the mailing or publication of notice, whichever occurs later, unless otherwise provided by the presiding officer). You must send a letter requesting intervention to the commission which is received by that date.

If a valid public hearing is requested, the Commission will forward the application to the State Office of Administrative Hearings (SOAH) for a hearing. If no settlement is reached and an evidentiary hearing is held, SOAH will submit a recommendation to the Commission for final decision. An evidentiary hearing is a legal proceeding similar to a civil trial in state district court.

A landowner with a tract of land at least 25 acres or more, that is partially or wholly located within the requested area, may file a written request with the Commission to be excluded from the requested area ("opt out") within (30) days from the date that notice was provided by the Utility. All opt out requests must include a large scale map and a metes and bounds description of the landowner's tract of land.

Persons who wish to request this option should file the required documents with the:

Public Utility Commission of Texas
Central Records
1701 N. Congress, P. O. Box 13326

Austin, TX 78711-3326

In addition, the landowner must also send a copy of the opt out request to the Utility. Staff may request additional information regarding your request.

Si desea informacion en español, puede llamar al 1-888-782-8477.

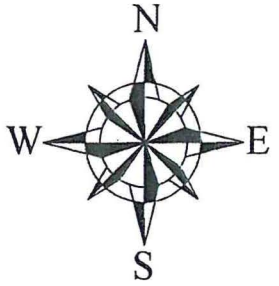
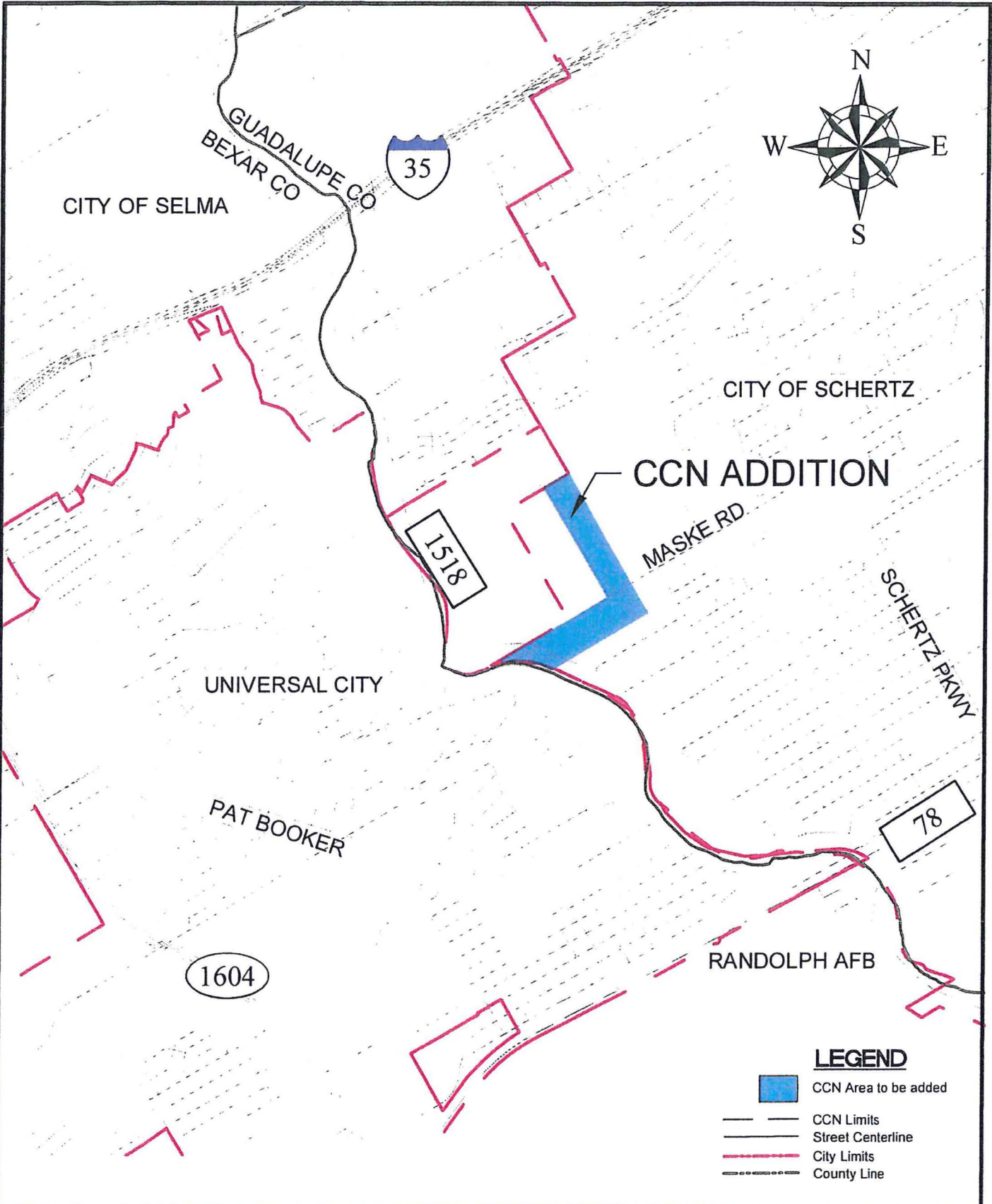

CCN ADDITION

LEGEND

- CCN Area to be added
- CCN Limits
- Street Centerline
- City Limits
- County Line

F **FORD ENGINEERING INC.**
 ENGINEERING SURVEYING PLANNING
 0927 WYE DRIVE, STE 104, SAN ANTONIO, TEXAS 78217 * P (210) 590-4777 * F (210) 590-4540
 TBPE No. F-1162 * WWW.FORDENGINEERING.COM * TBPLS No. 10018400

GENERAL LOCATION MAP

CITY OF SCHERTZ'S REQUESTED AREAS
 FOR BOTH WATER AND SEWER CCN
 CCN WATER - 10645, CCN SEWER - 20271

SCALE: NOT TO SCALE
 9/27/19
 FEI PROJ. 1124.9218



LEGEND

- CCN Area to be added
- CCN Limits
- Street Centerline
- County Line
- Property Line



STREET CENTERLINE BASED ON TxDOT STATEWIDE SH-SHAP FILES OBTAINED FROM TxDOT'S SHARED SERVICES DIVISION
 PARCEL MAP PREPARED BY FORD ENGINEERING, INC. BASED ON PROPERTY CORNERS LOCATED ON THE ORIGINAL LAND DEED RECORDS
 DATUM: NAD 83 TEXAS STATE PLANE SOUTH CENTRAL TEXAS 148 FOOT

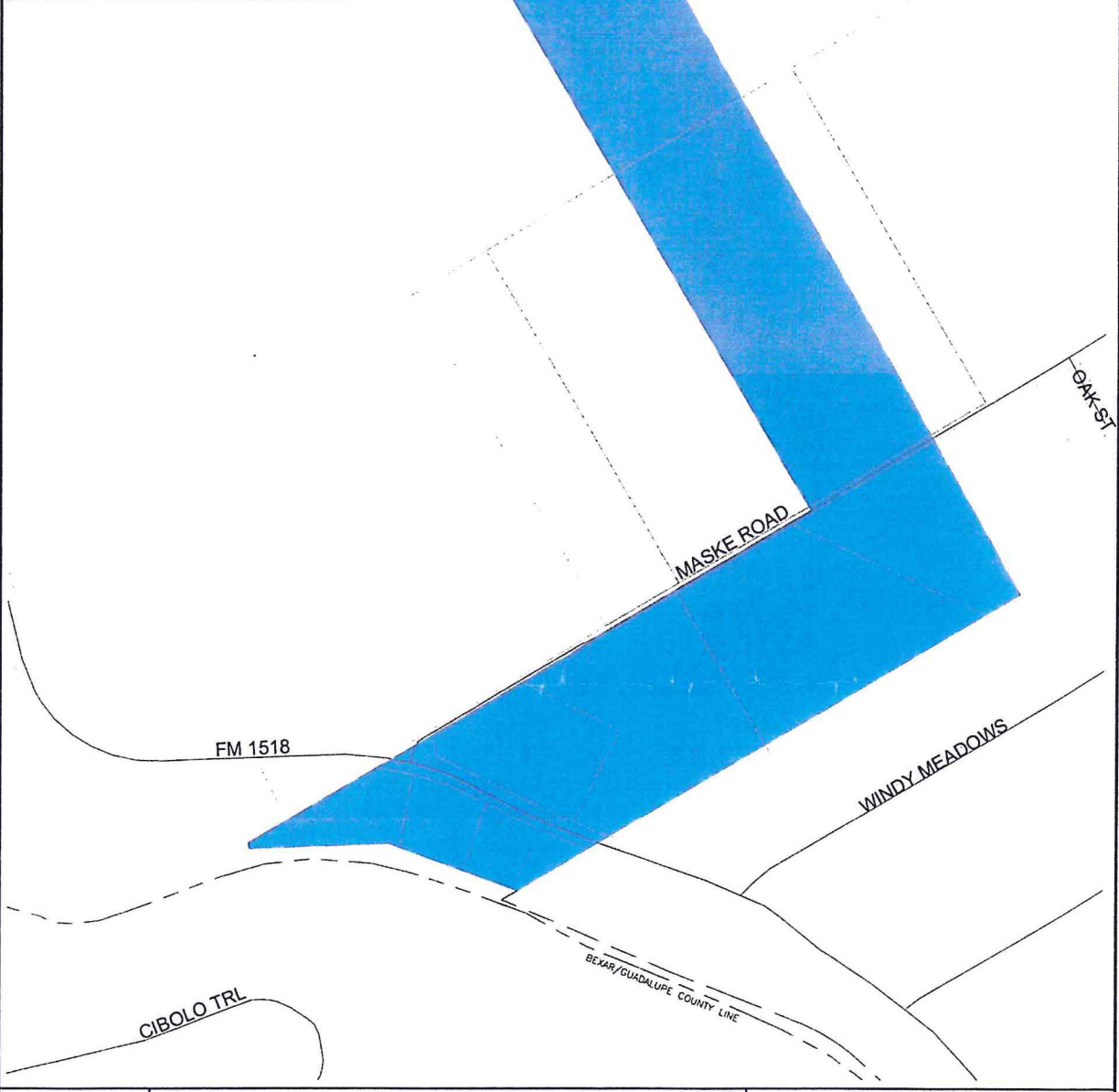

9/27/19
 FEI PROJ. 1124.9218

**CITY OF SCHERTZ'S REQUESTED AREAS
 FOR BOTH WATER AND SEWER CCN**

CCN WATER - 10645
 CCN SEWER - 20271

FORD ENGINEERING INC.

ENGINEERING • SURVEYING • PLANNING
 10627 WYE DRIVE, STE 104, SAN ANTONIO, TEXAS 78217 • P: (210) 593-4777 • F: (210) 593-4945
 TDP# N0: F-1182 • WWW.FORDENGINEERING.COM • TDP# S/N: 10015403